

eddissonwhite®



34 christchurch road, colliers wood, SW19 2NX

85 the broadway, wimbledon, SW19 1QE

109 london road, morden, SM4 5HP

W eddissonwhite.co.uk

T 020 8540 9828



Baltic Close, Colliers Wood

Offers In Excess Of £350,000 Leasehold

2 Double Bedrooms - Recently Renovated - Double Glazed
Communal Garden - Stunning Kitchen - Elegant Bathroom
Very Central Location - No Chain Sale - Stone's Throw To Tube
Next To Open Parkland - Proven Rental Yield - EPC 'TBC'



company registration no. 05068639 • vat registration no. 843560623



Baltic Close, Colliers Wood

Ground Floor

Approx. 50.0 sq. metres (538.2 sq. feet)

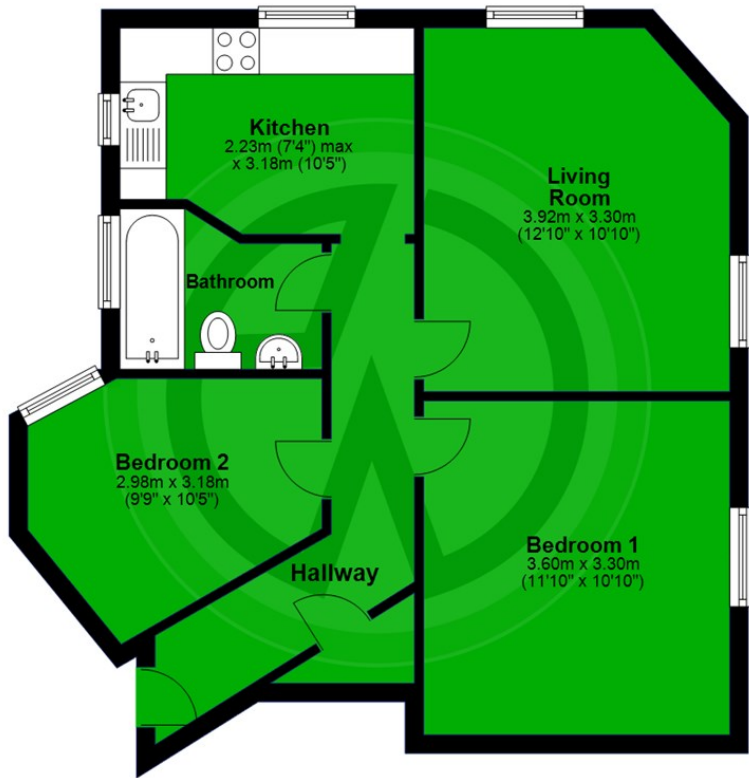

Whilst every attempt has been made to ensure the accuracy of the floor plan, measurements of doors, windows and rooms are approximate and no responsibility is taken for any error, omission or misstatement. These plans are for representation only and should be used as such by prospective purchasers. Specifically no guarantee is given on the gross internal floor area of the property if quoted on this plan and any figure given is for guidance only and should not be relied on as a basis of valuation.
Plan produced using PlanUp.

3 Oslo Court, Baltic Close, Colliers Wood

London Borough of Merton

Tax Band B

Leasehold

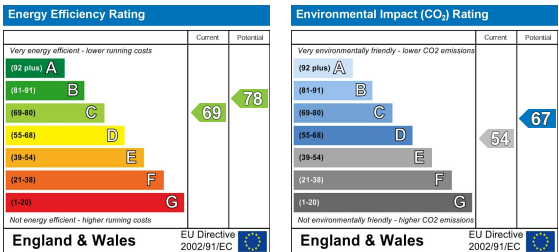

These details and any pictures or plans represent our opinion and are given in good faith for guidance only. They must not be construed as statements or fact. These particulars do not constitute part of an offer or contract. We have not tested the services, appliances or specified fittings and would highly recommend a purchaser to carry out their own survey on the property.